



# Detached Villa for sale in Nueva Andalucía, Marbella

4,250,000 €

Reference: R5352796 Bedrooms: 4 Bathrooms: 5 Plot Size: 1,035m<sup>2</sup> Build Size: 398m<sup>2</sup> Terrace: 134m<sup>2</sup>



**NOTA LEGAL:** La presente imagen es una representación aproximada y no contractual. Se reserva el derecho a efectuar durante el transcurso de la ejecución de las obras las modificaciones del proyecto que sean necesarias o convenientes por razones de orden técnico, legal o comercial, u ordenadas por cualquier administración u organismo público. Los elementos accesorios, tales como mobiliario y/o vegetación de jardinería, son meramente ilustrativos. Los giros de puertas y la distribución de aparatos sanitarios pueden no ser los definitivos. Las superficies indicadas están calculadas conforme al Decreto 218/2005 y son aproximadas.  
**LEGAL NOTICE:** This image is an approximate and non-contractual representation. The right is reserved to make any modifications to the project during the course of the construction work that may be necessary or appropriate for technical, legal, or commercial reasons, or as required by any administration or public body. Accessory elements, such as furniture and/or landscaping vegetation, are merely illustrative. Door swings and the layout of sanitary fixtures may not be final. The indicated surfaces are calculated in accordance with Decree 218/2005 and are approximate.



**NOTA LEGAL:** La presente imagen es una representación aproximada y no contractual. Se reserva el derecho a efectuar durante el transcurso de la ejecución de las obras las modificaciones del proyecto que sean necesarias o convenientes por razones de orden técnico, legal o comercial, u ordenadas por cualquier administración u organismo público. Los elementos accesorios, tales como mobiliario y/o vegetación de jardinería, son meramente ilustrativos. Los giros de puertas y la distribución de aparatos sanitarios pueden no ser los definitivos. Las superficies indicadas están calculadas conforme al Decreto 218/2005 y son aproximadas.  
**LEGAL NOTICE:** This image is an approximate and non-contractual representation. The right is reserved to make any modifications to the project during the course of the construction work that may be necessary or appropriate for technical, legal, or commercial reasons, or as required by any administration or public body. Accessory elements, such as furniture and/or landscaping vegetation, are merely illustrative. Door swings and the layout of sanitary fixtures may not be final. The indicated surfaces are calculated in accordance with Decree 218/2005 and are approximate.



**NOTA LEGAL:** La presente imagen es una representación aproximada y no contractual. Se reserva el derecho a efectuar durante el transcurso de la ejecución de las obras las modificaciones del proyecto que sean necesarias o convenientes por razones de orden técnico, legal o comercial, u ordenadas por cualquier administración u organismo público. Los elementos accesorios, tales como mobiliario y/o vegetación de jardinería, son meramente ilustrativos. Los giros de puertas y la distribución de aparatos sanitarios pueden no ser los definitivos. Las superficies indicadas están calculadas conforme al Decreto 218/2005 y son aproximadas.  
**LEGAL NOTICE:** This image is an approximate and non-contractual representation. The right is reserved to make any modifications to the project during the course of the construction work that may be necessary or appropriate for technical, legal, or commercial reasons, or as required by any administration or public body. Accessory elements, such as furniture and/or landscaping vegetation, are merely illustrative. Door swings and the layout of sanitary fixtures may not be final. The indicated surfaces are calculated in accordance with Decree 218/2005 and are approximate.



**NOTA LEGAL:** La presente imagen es una representación aproximada y no contractual. Se reserva el derecho a efectuar durante el transcurso de la ejecución de las obras las modificaciones del proyecto que sean necesarias o convenientes por razones de orden técnico, legal o comercial, u ordenadas por cualquier administración u organismo público. Los elementos accesorios, tales como mobiliario y/o vegetación de jardinería, son meramente ilustrativos. Los giros de puertas y la distribución de aparatos sanitarios pueden no ser los definitivos. Las superficies indicadas están calculadas conforme al Decreto 218/2005 y son aproximadas.  
**LEGAL NOTICE:** This image is an approximate and non-contractual representation. The right is reserved to make any modifications to the project during the course of the construction work that may be necessary or appropriate for technical, legal, or commercial reasons, or as required by any administration or public body. Accessory elements, such as furniture and/or landscaping vegetation, are merely illustrative. Door swings and the layout of sanitary fixtures may not be final. The indicated surfaces are calculated in accordance with Decree 218/2005 and are approximate.

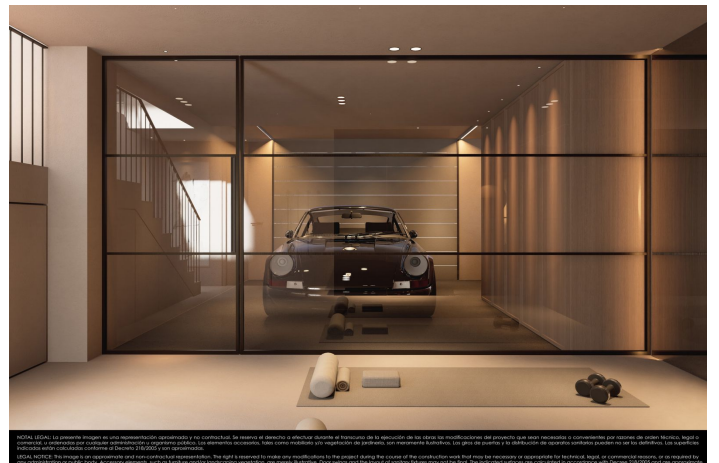

**NOTA LEGAL:** La presente imagen es una representación aproximada y no contractual. Se reserva el derecho a efectuar durante el transcurso de la ejecución de las obras las modificaciones del proyecto que sean necesarias o convenientes por razones de orden técnico, legal o comercial, u ordenadas por cualquier administración u organismo público. Los elementos accesorios, tales como mobiliario y/o vegetación de jardinería, son meramente ilustrativos. Los giros de puertas y la distribución de aparatos sanitarios pueden no ser los definitivos. Las superficies indicadas están calculadas conforme al Decreto 218/2005 y son aproximadas.  
**LEGAL NOTICE:** This image is an approximate and non-contractual representation. The right is reserved to make any modifications to the project during the course of the construction work that may be necessary or appropriate for technical, legal, or commercial reasons, or as required by any administration or public body. Accessory elements, such as furniture and/or landscaping vegetation, are merely illustrative. Door swings and the layout of sanitary fixtures may not be final. The indicated surfaces are calculated in accordance with Decree 218/2005 and are approximate.



---

## Costa del Sol, Nueva Andalucía

Nestled in the heart of Nueva Andalucía's prestigious Golf Valley, this exceptional 4-bedroom villa offers the perfect blend of contemporary luxury, complete privacy, and prime location. Set within an exclusive gated community with 24-hour security, the property enjoys a sought-after south-facing orientation, flooding the home with natural light throughout the day.

Fully renovated to the highest standards by renowned Nmobé Architects Marbella, the villa boasts 400m<sup>2</sup> of elegant interior space on a generous 1,000m<sup>2</sup> plot. The design centres around a stylish open-plan kitchen that flows effortlessly into the spacious living and dining areas—perfect for modern living and entertaining.

All four bedrooms feature en-suite bathrooms, ensuring maximum comfort and privacy. Designed as a private wellness retreat, the villa includes a fully equipped gym and sauna, complemented by a heated private pool set within beautifully secluded outdoor spaces.

Located just 5 minutes from Puerto Banús, residents enjoy easy access to world-class dining, luxury shopping, and vibrant nightlife, while being surrounded by some of Marbella's most renowned golf courses, including Los Naranjos, Aloha, and Las Brisas.

Offering complete privacy, cutting-edge design, and an unbeatable location, this property also benefits from an expedited delivery timeline, with completion scheduled for Q3 this year, making it an outstanding turnkey opportunity in one of Marbella's most desirable areas.



## Features:

### Features

Covered Terrace  
Private Terrace  
Storage Room  
Ensuite Bathroom  
Fitted Wardrobes  
Gym  
Sauna  
Utility Room  
Barbeque  
Basement  
Fiber Optic

### Views

Mountain  
Country  
Pool

### Pool

Heated  
Private Pool

### Garden

Private Garden

### Category

Luxury

### Orientation

South

### Setting

Close To Golf  
Close To Port  
Close To Sea  
Close To Shops  
Close To Town  
Close To Schools

### Furniture

Optional

### Security

Gated Complex  
24 Hour Security  
Alarm System  
Electric Blinds

### Energy Rating

B

### Climate Control

Air Conditioning  
Fireplace  
U/F Heating  
U/F/H Bathrooms

### Condition

Excellent  
New Construction

### Kitchen

Partially Fitted  
Kitchen-Lounge

### Parking

Private

### CO2 Emission Rating

B