

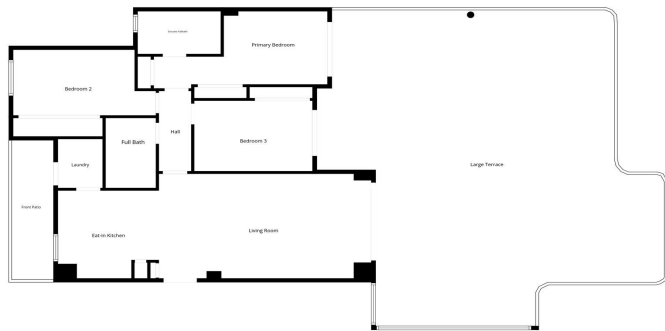

Middle Floor Apartment for sale in Estepona, Estepona

929,900 €

Reference: R5325421 Bedrooms: 3 Bathrooms: 2 Build Size: 283m²



Floor Plan Created By Cubicase App. Measurements Deemed Highly Reliable But Not Guaranteed.

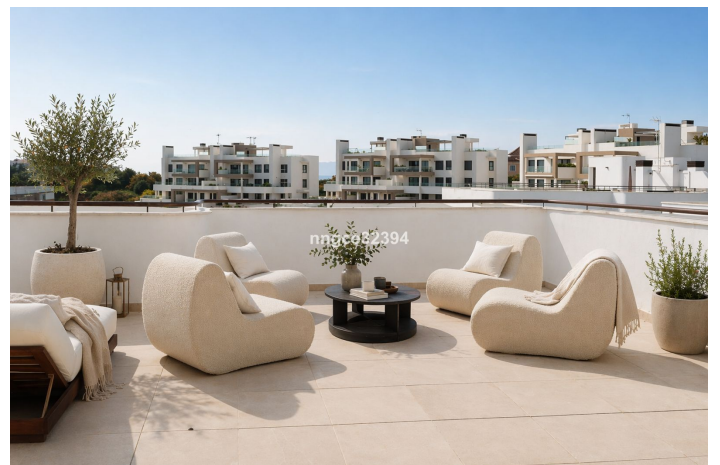



Costa del Sol, Estepona

Brand new and just completed, this exceptional sea-view residence is perfectly positioned beside Las Mesas Park in Estepona, only 2-3 minutes by car or around 10 minutes on foot to the marina, beaches, restaurants, cafés and town centre.

Beautifully designed for a relaxed coastal lifestyle, the apartment combines refined contemporary interiors with effortless indoor-outdoor living. Bright open-plan spaces flow directly onto an impressive oversized private terrace – a standout feature of the home and an extraordinary extension of the living space.

Created for long sun-filled days and warm evenings, the terrace offers generous room for outdoor lounging, dining, entertaining and year-round enjoyment, all enhanced by open sea views and tranquil green surroundings.

Set within a newly completed premium development, residents enjoy an exclusive collection of resort-style amenities including adult and children's swimming pools, a fully equipped gym, sauna and landscaped gardens.

Private garage parking and a separate trastero/storage room are included.

Sophisticated yet effortless, this is an ideal permanent residence, elegant holiday escape or prime investment opportunity in one of Estepona's most desirable new addresses.

Features

Brand new / just completed

Beautiful sea views

Beside Las Mesas Park

Exceptional oversized private terrace

Adult and children's swimming pools

Fully equipped gym

Sauna

Private garage parking

Private trastero / storage room

Lift access

10-minute walk to marina & beach

Close to shops, dining & amenities

Ideal home, holiday retreat or investment

Modern Mediterranean luxury with sea views, resort amenities and one of Estepona's most lifestyle-driven locations.



Features:

Features

Covered Terrace
Lift
Near Transport
Private Terrace
Storage Room
Ensuite Bathroom
Marble Flooring
Double Glazing
Fitted Wardrobes
Solarium
WiFi
Gym
Sauna
Utility Room
Domotics
Restaurant On Site
Near Mosque
Staff Accommodation
Near Church
Fiber Optic
Access for people with reduced mobility

Views

Sea Views
Garden
Pool
Courtyard

Pool

Communal
Children`s Pool

Garden

Communal
Landscaped

Utilities

Orientation

South
South East
South West

Setting

Beachside
Close To Port
Urbanisation
Close To Sea
Close To Shops
Close To Town
Close To Schools
Town
Port
Close To Forest
Close To Marina

Furniture

Fully Furnished
Optional

Security

Gated Complex
24 Hour Security
Alarm System
Electric Blinds
Entry Phone

Category

Climate Control

Air Conditioning
Pre Installed A/C
Cold A/C
Hot A/C

Condition

Excellent

Kitchen

Fully Fitted
Kitchen-Lounge

Parking

Underground
Garage
Communal



Electricity
Drinkable Water
Telephone

Holiday Homes
Investment
Luxury
Resale
Contemporary