

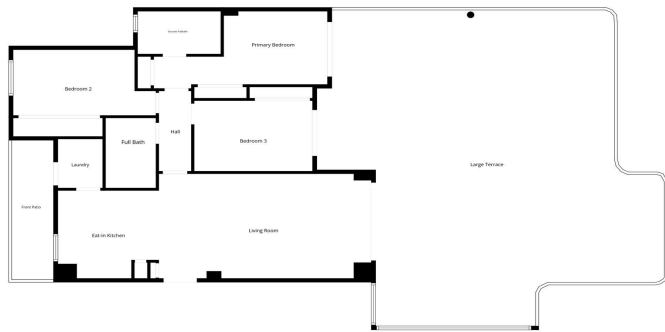

Apartamento Planta Media en venta en Estepona, Estepona

929.900 €

Referencia: R5325421 Dormitorios: 3 Baños: 2 Construido: 283m²



Floor Plan Created By Cubicase App. Measurements Deemed Highly Reliable But Not Guaranteed.

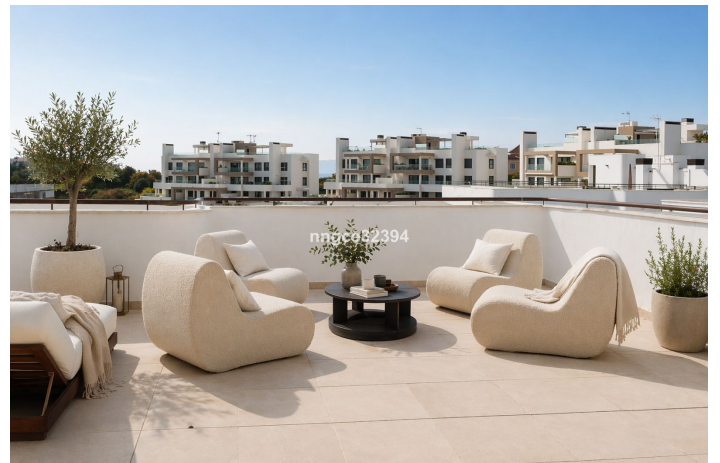



Costa del Sol, Estepona

Brand new and just completed, this exceptional sea-view residence is perfectly positioned beside Las Mesas Park in Estepona, only 2-3 minutes by car or around 10 minutes on foot to the marina, beaches, restaurants, cafés and town centre.

Beautifully designed for a relaxed coastal lifestyle, the apartment combines refined contemporary interiors with effortless indoor-outdoor living. Bright open-plan spaces flow directly onto an impressive oversized private terrace – a standout feature of the home and an extraordinary extension of the living space.

Created for long sun-filled days and warm evenings, the terrace offers generous room for outdoor lounging, dining, entertaining and year-round enjoyment, all enhanced by open sea views and tranquil green surroundings.

Set within a newly completed premium development, residents enjoy an exclusive collection of resort-style amenities including adult and children's swimming pools, a fully equipped gym, sauna and landscaped gardens.

Private garage parking and a separate trastero/storage room are included.

Sophisticated yet effortless, this is an ideal permanent residence, elegant holiday escape or prime investment opportunity in one of Estepona's most desirable new addresses.

Features

Brand new / just completed

Beautiful sea views

Beside Las Mesas Park

Exceptional oversized private terrace

Adult and children's swimming pools

Fully equipped gym

Sauna

Private garage parking

Private trastero / storage room

Lift access

10-minute walk to marina & beach

Close to shops, dining & amenities

Ideal home, holiday retreat or investment

Modern Mediterranean luxury with sea views, resort amenities and one of Estepona's most lifestyle-driven locations.



Características:

Características

Terraza Cubierta
Ascensor
Cerca de Transporte
Terraza Privada
Trastero - Almacén
Baño En-Suite
Suelos de Mármol
Doble acristalamiento
Armarios Empotrados
Solario
WiFi
Gimnasio
Sauna
Lavadero
Domotica
Restaurant
Cerca de la Mezquita
Alojamiento del personal
Cerca de una Iglesia
Fibra óptica
Access for people with reduced mobility

Vistas

Vistas al Mar
Vistas a Jardín
Vistas a Piscina
Vistas a Patio

Piscina

Piscina Comunitaria
Children`s Pool

Jardín

Jardín Comunitario
Jardín Paisajístico

Servicios Públicos

Orientación

Sur
Orientación Sureste
Orientación Suroeste

Posición

Lado de la Playa
Cerca de Puerto
Urbanización
Cerca del Mar
Cerca de Tiendas
Cerca de Ciudad
Cerca de Colegios
Ciudad
Puerto
Cerca de los Bosques
Cerca de Marina

Muebles

Completamente Amueblada
Opcionales

Seguridad

Recinto Cerrado
Seguridad de 24 horas
Alarma
Persianas Eléctricas
Portero Automático

Categoría

Climatización

Aire Acondicionado
A/A Preinstalado
A/A Frio
A/A Caliente

Estado

Excelente estado de conservación

Cocina

Cocina Equipada
Kitchen-Lounge

Aparcamiento

Párking Subterráneo
Garaje
Párking Comunitario



Electricidad
Agua Potable
Teléfono

Casas de vacaciones
Inversion
Lujo
Reventa
Contemporáneo